

AMF SERIES

PERMANENT MAGNET DRIVEN PUMP



Energy Saving Design



New type large flow, high head design
Head above 35M, Max flow 1350L/min

AMF SERIES

PERMANENT MAGNET DRIVEN PUMP

GFRPP or PVDF wet end materials

- Corrosion resistance.
- High temp up to 90°C (PVDF material).
- Compact size.
- Lighter weight

AMF series permanent magnet direct drive pump

High efficiency design

IE5 motor, Frequency conversion control, energy and cost saving;

Light weight embedded design

Light weight small size, compact structure, modular components, easy to maintain;

Corrosion resistance design

The protection above IP66, integrated plastic shell, excellent corrosion resistance;

Super quiet design

No cooling fan, low temperature rises;

Patented product design

MATERIAL

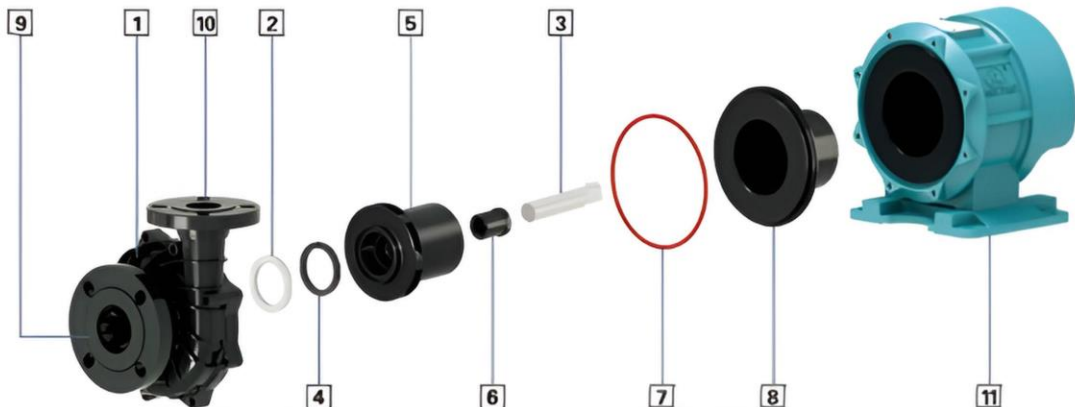

NO.	Description	ACE	ACV	ARE	ARV	AAE	AAV	SSE	SSV
1	Pump casing	GFRPP/CFRPP/ PVDF/ CFRETFE							
2	Front thrust ring	CERAMIC						SSIC	
3	Shaft	CERAMIC						SSIC	
4	Wear resistant ring	PTFE						SSIC	
5	Impeller unit	GFRPP/CFRPP/ PVDF/ CFRETFE							
6	Bearing	CARBON		PTFE		CERAMIC		SSIC	
7	O-Ring <i>Note</i>	EPDM	VITON	EPDM	VITON	EPDM	VITON	EPDM	VITON
8	Rear casing	GFRPP/CFRPP/ PVDF/ CFRETFE							
9	Inlet adjustable flange	GFRPP/CFRPP/ PVDF/ CFRETFE							
10	Outlet adjustable flange	GFRPP/CFRPP/ PVDF/ CFRETFE							
11	Motor								

AMF

AMF series permanent magnet direct drive pump

MODEL IDENTIFICATION

AMF - 5 4 2 F G A C V - 3

① ② ③ ④ ⑤ ⑥ ⑦ ⑧ ⑨ ⑩

① Series Symbol	AMF	⑤ Type of Connection	F: Flange U: Union
② Suction Size	2:25A(1") 4:40A(1½") 5:50A(2") 6:65A(2½") 8:80A(3")	⑥ Casing Material	G: GFRPP P: PVDF C: CFRPP E: CFRETFE
③ Discharge Size	2:25A(1") 4:40A(1½") 5:50A(2") 6:65A(2½")	⑦ Shaft Material	A: CERAMIC S: SSIC T: TI
④ Motor Power	0: 1/2HP(0.37kW) 1: 1HP(0.75kW) 2: 2HP(1.5kW) 3: 3HP(2.2kW) 5: 5HP(3.7kW) 7: 7.5HP(5.5kW) 8: 10HP(7.5kW)	⑧ Bearing Material	A: CERAMIC C: CARBON R: PTFE S: SSIC
		⑨ O-Ring Material	E: EPDM V: VITON K: FFKM
		⑩ Voltage	2:220V 3:380V 4:415V

Note: O-ring can choose FFKM.

Model Specification

Model	Inlet x Outlet	Rated Flow (L/min)	Rated Head (m)	Max.Capacity (L/min)	Max. Head (m)	Motor output (kW)
AMF-220	25 x 25	50	14	150	16	0.37
AMF-221	25 x 25	50	21	180	22	0.75
AMF-222	25 x 25	50	34	180	36	1.5
AMF-223	25 x 25	50	35	180	38	2.2
AMF-440	40 x 40	100	11	240	13	0.37
AMF-441	40 x 40	150	15.5	330	19.5	0.75
AMF-542	50 x 40	200	22	450	25.5	1.5
AMF-552	50 x 50					
AMF-542H	50 x 40	100	26.5	250	27.5	1.5
AMF-552H	50 x 50					
AMF-543	50 x 40	250	26	500	31.5	2.2
AMF-553	50 x 50					
AMF-543H	50 x 40	150	32	300	34	2.2
AMF-553H	50 x 50					
AMF-545	50 x 40	250	31	520	35	3.7
AMF-555	50 x 50					
AMF-653	65 x 50	450	16	600	20	2.2
AMF-655	65 x 50	500	25	860	28.5	3.7
AMF-662	65 x 65	600	9	900	14	1.5
AMF-663	65 x 65	650	11	1050	17	2.2
AMF-665	65 x 65	750	15	1230	21	3.7
AMF-867	80 x 65	800	22.5	1140	28.5	5.5
AMF-868	80 x 65	800	29	1350	33	7.5

Equipment **Smart Feature** and **Automation** Capability

Application Example

Automatic regulate and maintain the chemical flowrate in wet process industry

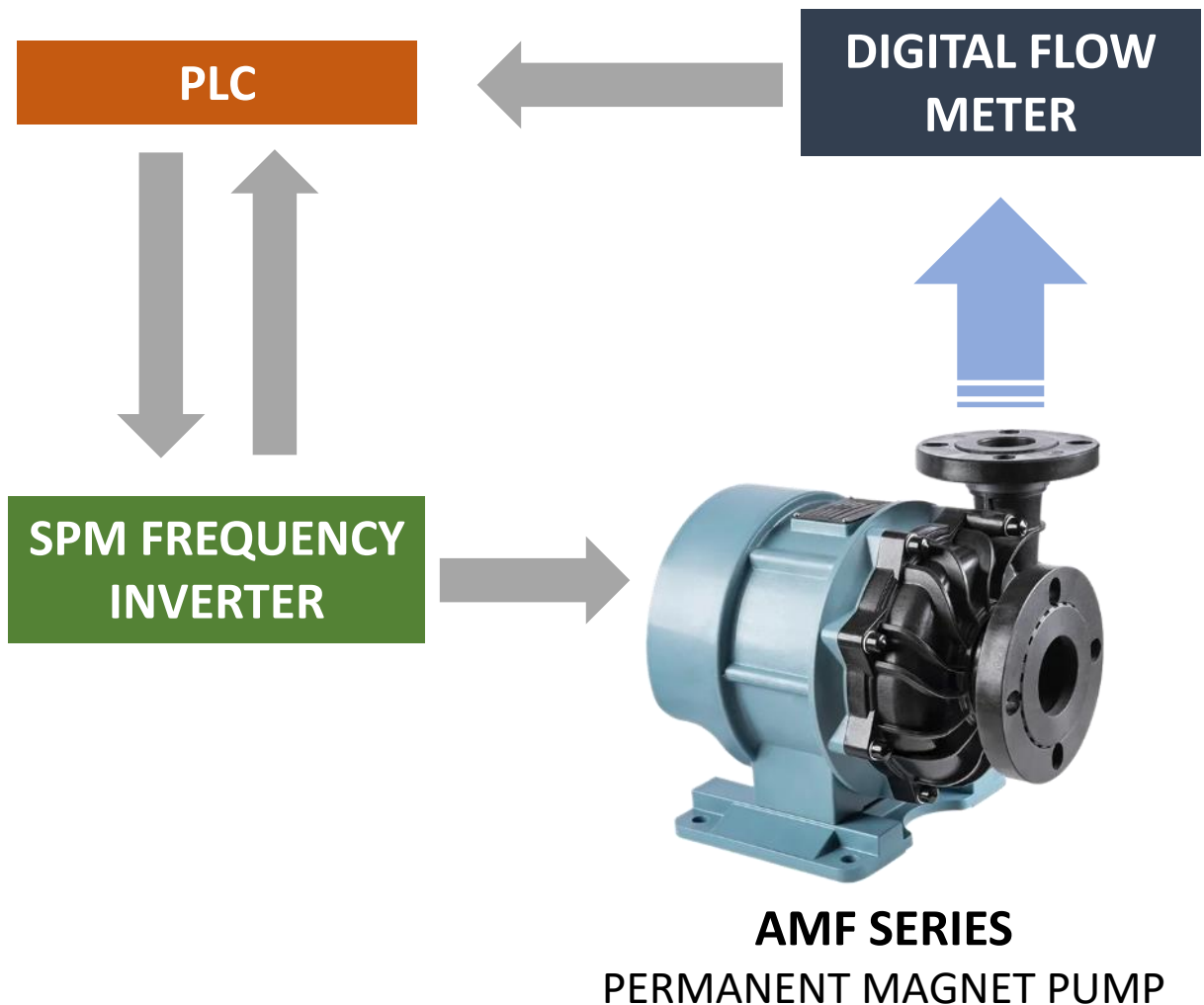

Equipment **Smart Feature** and **Automation** Capability

Application Example

Chemical circulation in the plating machines



Asia Pump (M) Sdn. Bhd.



No. 14 Jalan IKS Bukit Tengah
Taman IKS Bukit Tengah
14000 Bukit Mertajam, Penang, Malaysia



+60-124258646 (Ms. Thor)



sales@asiapump.com.my



www.asiapump.com.my